



# West Midlands Woodturners

## November 2018 Newsletter



### Programme of meetings

Venue: Water Orton Primary School, unless otherwise stated.

18th November	Hands On & AGM
16th December	Demo: <a href="#">Steve Heeley</a> & Christmas “buffet”

### Annual General Meeting 18th November 2018.

Notice is hereby given that the AGM of West Midlands Woodturners will take place at Water Orton Primary School at 10.00 am on Sunday 18th November 2018.

Any items for the agenda should be sent to the secretary 14 days prior to the meeting .

**Annual subscriptions for the 2018/9 year will be confirmed at the Annual General Meeting and are due immediately thereafter. Please bring your cheque books (or lots of cash!)**

**Demonstration days** start at 9.15 am and conclude around 4.30 pm.

(Setting up from 8.30 am)

Hands On days start at 9.30 am and conclude about 4.00 pm.

Don't forget your lunch and a mug!

### Programme of Meetings for 2019

Venue: Water Orton Primary School, unless otherwise stated.

20th January	Hands On	Texturing
17th February	Demo:	<a href="#">Mark Sanger</a>
17th March	Hands On	Pewter and other materials
14th April (not 3rd Sunday)	Demo:	<a href="#">Rick Dobney</a>
19th May	Hands On	Pens
9th June (not 3rd Sunday)	Demo:	<a href="#">Mick Hanbury</a>
21st July	Hands On	Pyrography
18th August	Demo:	<a href="#">Gary Rance</a>
15th September	Hands On	Sharpening and work holding
20th October	Demo:	<a href="#">Greg Moreton</a>
17th November	Hands On & AGM	
15th December	Demo:	<a href="#">Steve Heeley</a> & Christmas “buffet”

Some of the 2019 Programme of meetings is dependent on the availability of a suitable venue and are therefore subject to change.

## WMWT Committee

Chairman	Steve Simmons	Chair@wmwoodturners.org.uk
Vice Chair	Vacant	Vice@wmwoodturners.org.uk
Secretary & Director	John Hooper	Secretary@wmwoodturners.org.uk
Treasurer	Pete Blakey	Treasurer@wmwoodturners.org.uk
Programme and Events Manager	Malcolm Thorpe	Events@wmwoodturners.org.uk
Equipment Manager	Malcolm Edwards	Equipment@wmwoodturners.org.uk
Membership Secretary	Vacant	Membership@wmwoodturners.org.uk
Newsletter Editor	Rob Huxley	Editor@wmwoodturners.org.uk

### **Annual General Meeting: 18<sup>th</sup> November 2018**

**Notice is hereby given that the**

**Annual General Meeting of West Midlands Woodturners**

**(a company limited by guarantee)**

**will be held at Water Orton Primary School at:**

**10.00am on Sunday 18<sup>th</sup> November 2018.**

The number of chairs in the school hall appears to have reduced somewhat in recent months so it would be advisable to bring your own folding chair.

## Contents

Page No	Item
2	AGM
3	Chairman's comments
	Free Christmas Raffle
4-7	Review of Paul Jones demonstration
8	Cliffs Corner
9	Chairman's Challenge
10	Chairman's Challenge November
	Display Table October
11	Subscription reminder
	Acknowledgment

## Chairman's Comments

Seven WMWT members attended the recent AWGB seminar at Yarnfield Training and Conference Centre on the 5<sup>th</sup>- 7<sup>th</sup> October. The facilities at Yarnfield were such an improvement on the old venue of Loughborough. It was a thoroughly enjoyable weekend and the demonstrators that I did get to see were excellent. I would recommend to everyone to consider attending a seminar if they have the opportunity.

The October demonstration given by Paul Jones was attended by 47 members and 2 visitors. It was very pleasing to see so many members there.

The Chairman's challenge attracted 7 entries and as always the standard of craftsmanship was very high, thank you to all who entered.

There were 37 high quality pieces bought in for the display table, this beat even last month's number of entries. I am amazed every month at the high quality of work produced by club members and would thank you all for bringing your work in for display. It is a good way of showing visitors the talent that we have in the club.

The raffle was generously supported and £76 was raised, thank you to everyone.

The next meeting on the 18<sup>th</sup> November will include the A G M. There are some very important issues to discuss regarding the closure of the School due to HS2. It is important that as many members as possible attend the A G M so that we can discuss what options are open to us.

So see you all on the 18<sup>th</sup> November.

Steve

December Meeting 16th December 2018



### FREE CHRISTMAS RAFFLE

In addition to our normal raffle on the 16th, There will be a free raffle for all members who attend the December Demo meeting to win a superb prize .

Please collect your free raffle ticket when you sign in.

The Free raffle will be drawn at 3.00pm, you will need to be in attendance at the draw to claim the prize with the winning ticket.

Report on the Demonstration by Paul Jones on 21<sup>st</sup>. October 2018.

This was Paul's first visit to West Midlands Woodturners during which he showed us a variety of tools and techniques to help us enhance our turning.

His first item was a decorated, lidded box with an integral finial on the lid. For this he used a seasoned Ash log of approx. 7" diameter by 7" long mounted between centres. After removing the bark by hand, he roughed the log down to a cylinder and formed a long spigot to suit the O'Donnell jaws fitted to his chuck to hold the blank in compression mode. After truing up the end face, he started shaping the outside of the bowl, aiming for a smooth curve to give the piece an oriental look. Having decided on the diameter of the opening, he marked this on the end and turned away some more of the face leaving a small rim. He then textured the face with a bead cutting tool on the area between the rim and where the entry hole would be. Next, using a larger bead cutting tool, he cut beads all the way down the outside of the form

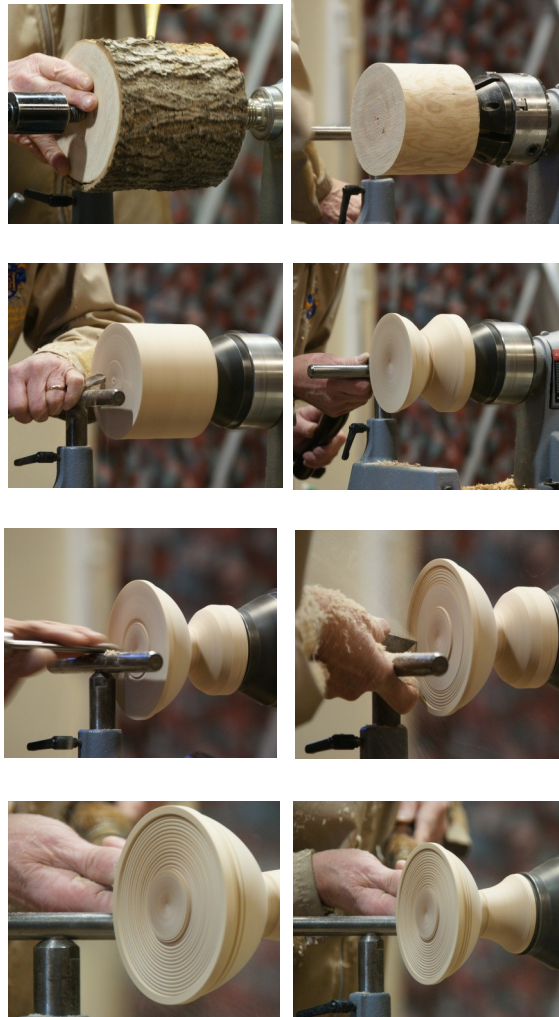

from the rim to the base, hoping to get some tear-out on the way.

The next step was to burn the outside and top with a blow torch, aiming to get charring right down to the bottom of the beads. With the dust extraction on, and the lathe stationary, Paul then brushed the burnt areas with a stiff bristled scrubbing brush to remove all the loose carbon. This was then repeated with the lathe running to produce a slight lustre to the work. Using a "verdigris" wax polish, he applied it all over the piece with a cloth, working it well into the bottom of the beads. Still with the lathe stationary, a hot air gun was then used to soften the wax and the excess rubbed off with a cloth. Final polishing was then achieved with the lathe running, followed by a coat of shellac sanding sealer which was sprayed on.

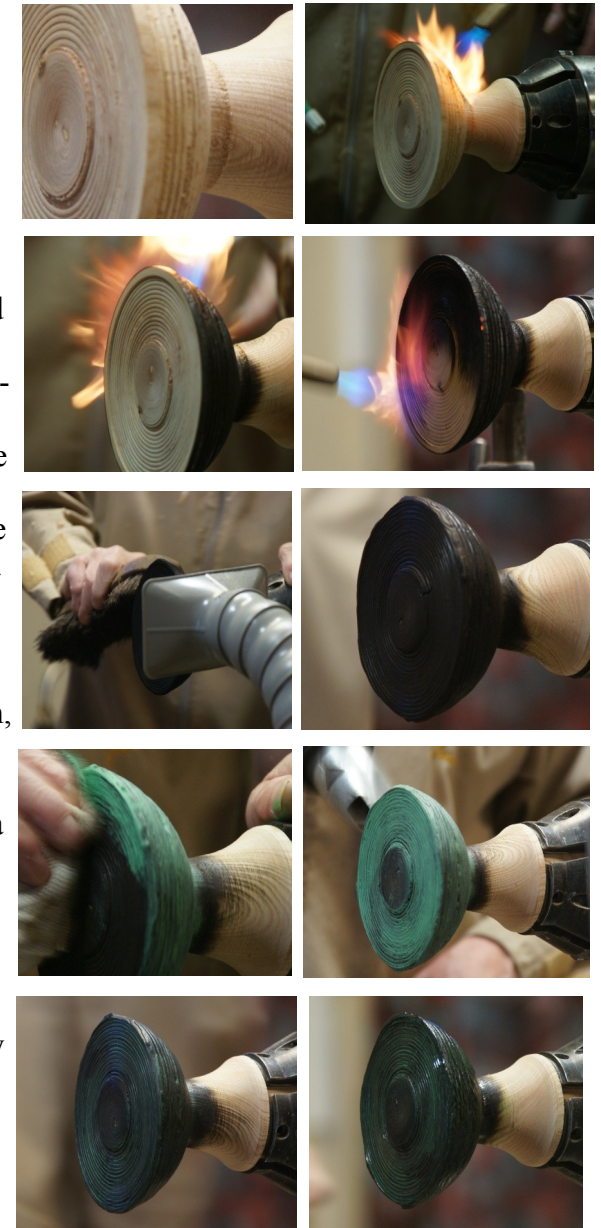

To start the hollowing, Paul cut a hole down the centre, to the required depth, by using a bowl gouge, held horizontally, and pushed straight in. The rest of the hollowing was then done, firstly with a Simon Hope straight tool with a 10 mm tip, and then with a swan necked tool to achieve the undercut he wanted. The entrance hole was then cleaned up to make it parallel and sanded through the grits. After sealing the wood with shellac sanding sealer, and applying carnuba wax, Paul polished the entrance with a cloth. With the work left on the chuck, the chuck was removed from the lathe and put aside for later.

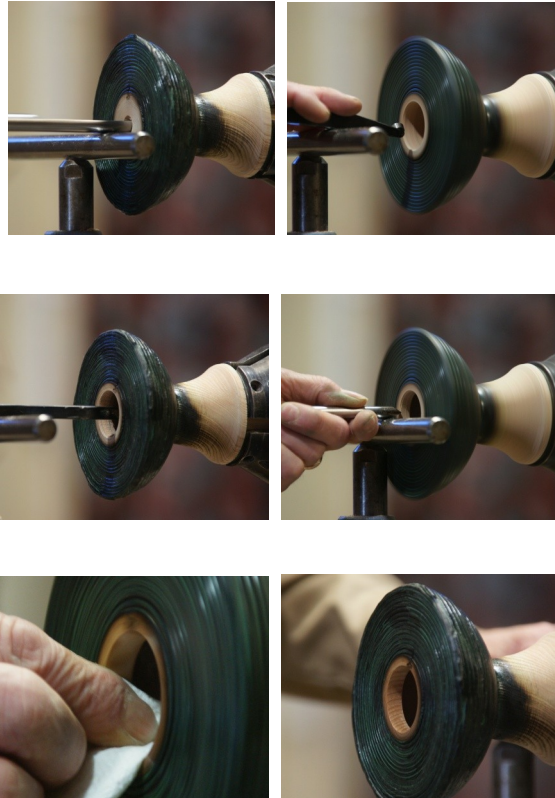

To make the lid, a separate blank was placed between centres, roughed to the round and a spigot cut at the tail stock end. This was then held in a separate chuck in compression, and the end faced off. The diameter of the hole in the base part was transferred to the face and wood turned away down to this line.

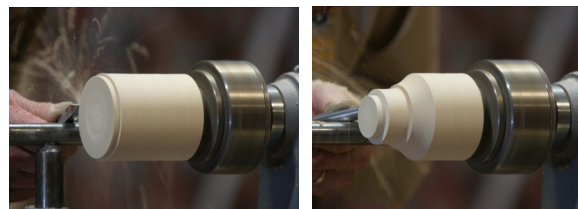

The final fit was achieved by sanding the spigot and a process of trial and error.

The end was then dished and using a three point tool a series of beads was cut on the end matching those on the outside of the base part. When happy with this, Paul started shaping the rest of the lid which included a spherical finial. After the usual finishing, and using a jig to hold the drill at the desired angle, he drilled a hole through the centre of the sphere. With the lathe revolving at its lowest speed, the lid was sprayed with ebonising lacquer and left to dry. It was then parted off and a bundle of thin sycamore strips passed through the hole in the finial.

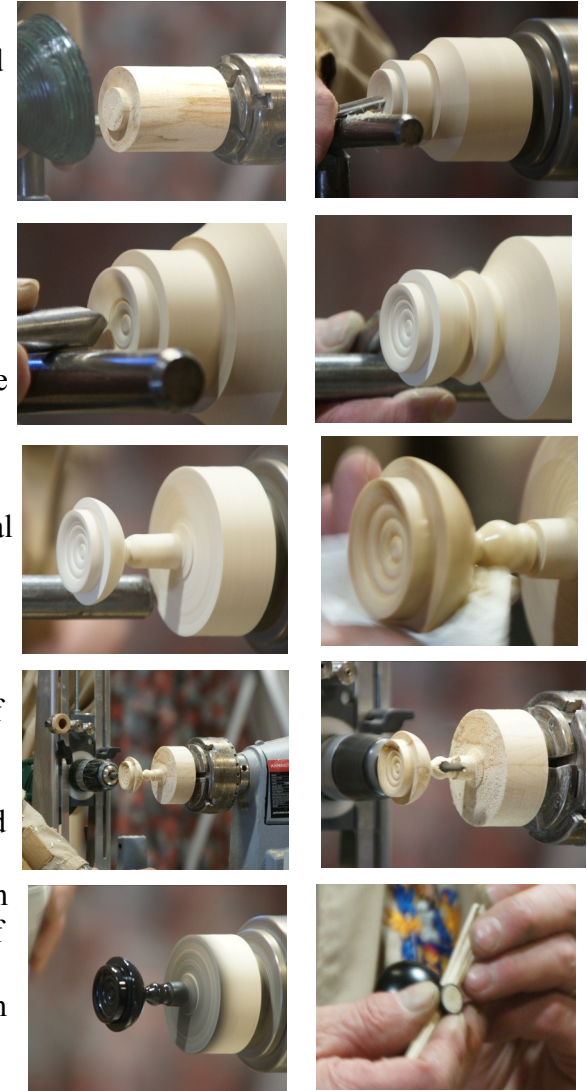

The wood left in the chuck was turned to about 15 mm diameter for a short length and a hole drilled through the centre. This was to make two bamboo cane shaped collars which were parted off and one placed at each end of the sycamore strips to hold them in place.

The chuck containing the base part was returned to the lathe and the base parted off. Using the wood still left in the chuck, Paul formed a jam chuck to hold the bowl by its entrance hole while he finished the underside of the piece. To do this, he dished the base, cut a groove in it, and with a piece of Formica and with the lathe running at a higher speed, burned the base of the groove.

The second piece was to be another hollow form with lid. For this, Paul mounted a fruit-wood log between centres, roughed it down to a cylinder and turned a spigot at one end to hold it, in

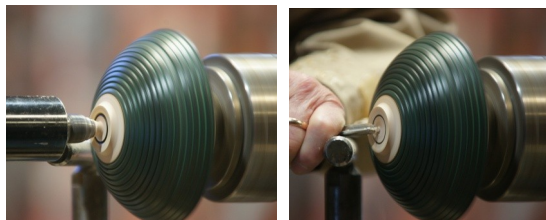
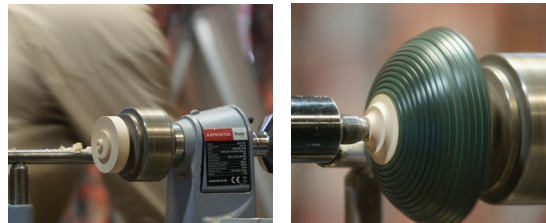
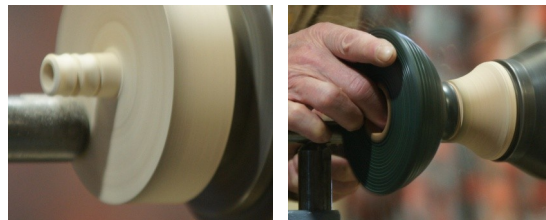
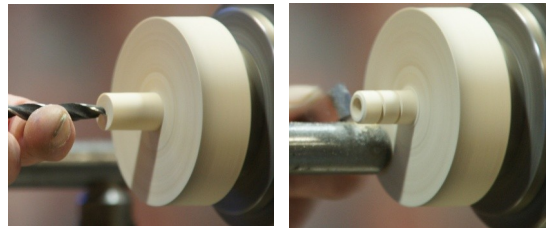

compression, in the O'Donnell jaws of his chuck. The other end was then trued up, its centre marked and a tenon turned on the end. The shape of the whole piece was then roughed out, and the part which was to form the lid was parted off. The hollowing out was achieved in the same way as the previous piece using a Simon Hope tool. The work was left in the chuck, but the chuck removed from the lathe. The piece previously parted off for the lid was then placed in another chuck and a spigot turned on the end to fit the hollowed bottom. The first chuck was then returned to the lathe, the lid attached and held in place by the tailstock. Paul then turned the whole piece down to its finished shape, blending the two parts into a smooth curve.

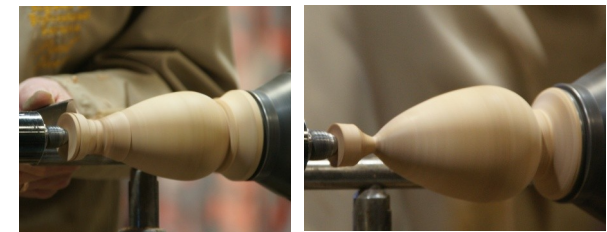
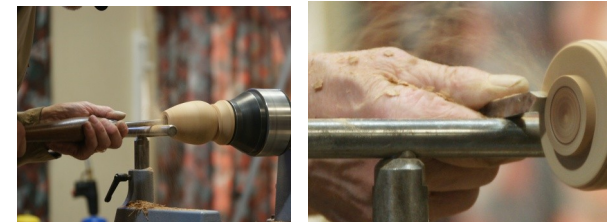
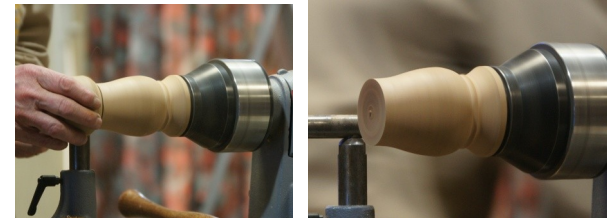
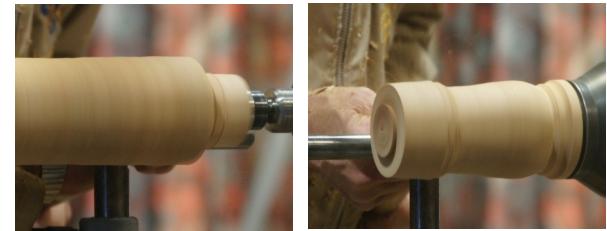

Deciding to decorate the piece with beads, he set a pair of dividers to 5mm and starting at the bottom divided the distance into 5 mm sections. (There was a feeling that it would have been better to have started at the junction of the base with the lid in order to disguise this in the finished item.) Starting at the bottom, and using the triangular tool, he turned the left hand side of each bead, and then starting at the top, he turned the right hand side of each bead.

The next job was to saw off the top part of the lid at an angle and to give it a curvy look by carving some of it away with a knife. The whole thing was then parted off from the waste piece left in the chuck from which he turned a jam chuck to hold the bottom section while finishing off its base.



The third item was to be a scoop. For this, Paul used a piece of sycamore 2" square by 10" long mounted directly in the chuck; i.e. without first cutting a spigot. This was roughed to the round and, deciding it was too long, he parted off about 4" of the length. Working with what was left in the chuck, he produced a smooth finish by using a skew chisel and faced off the end. As before, he started the hollowing by pushing a bowl gouge straight into the centre of the wood to the required depth and continued hollowing with the same tool, aiming for an even wall thickness all the way down to the bottom. The inside was then sanded and the outer shape refined and sanded. Forming the handle came next followed by locking the lathe shaft so that the top part of the bowl could be sawn off to form the open scoop. The cut edges were then sanded to blend in with the rest. Finally, with the lathe unlocked, the finished scoop was parted off from the waste piece left in the chuck

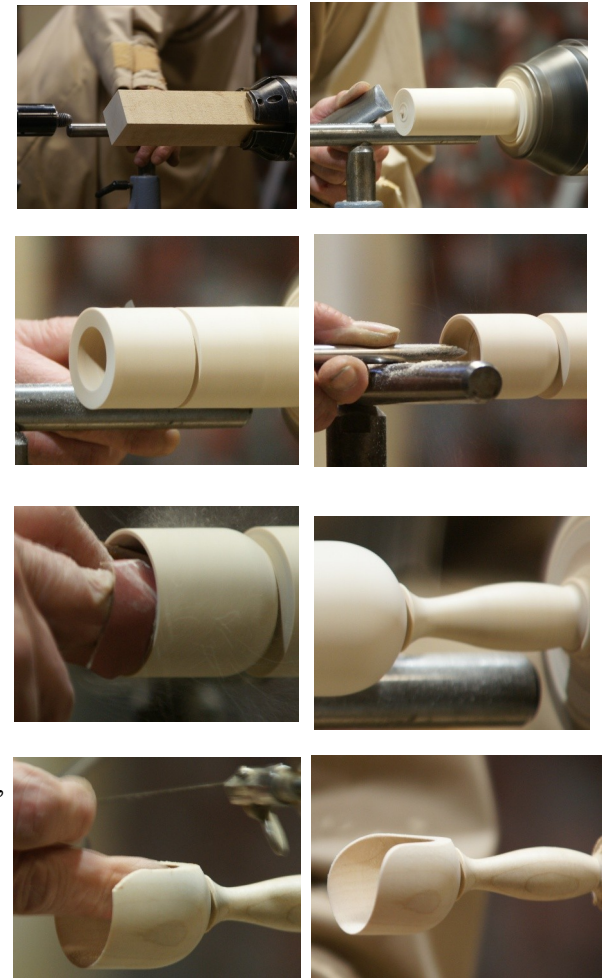

Malcolm Caine.

## Cliff's corner

### A Letter to God

There was a man who worked for Royal Mail whose job it was to process all the mail that had illegible addresses. One day a letter came addressed in a shaky handwriting to God with no actual address or postcode. He thought he should open it to see what it was about. The letter read:

Dear God.

I am an 83 year old widow, living on a very small pension.

Yesterday someone stole my purse. It had £100 in it, which was all the money I had until my next pension payment. Next Sunday is my birthday, and I had invited two of my friends over for dinner. Without that money, I have nothing to buy food with, have no family to turn to, and you are my only hope.

Please help me?

Sincerely,

Edna

The postal worker was touched. He showed the letter to all the other workers. Each one dug into his or her wallet and came up with a few pounds. By the time he made the rounds, he had collected £96, which he put into an envelope and sent to the woman. The rest of the day, all the workers felt a warm glow thinking of Edna and the dinner she would be able to share with her friends.

A few days later, another letter came addressed to God in the same hand.

All the workers gathered around while the letter was opened. It read:

Dear God.

How can I ever thank you enough for what you did for me? Because of your gift of love, I was able to fix a glorious dinner for my friends. We had a very nice day and I told my friends of your wonderful gift.

By the way, there was £4 missing. I think it might have been those b..... at the sorting office..

Sincerely.

Edna

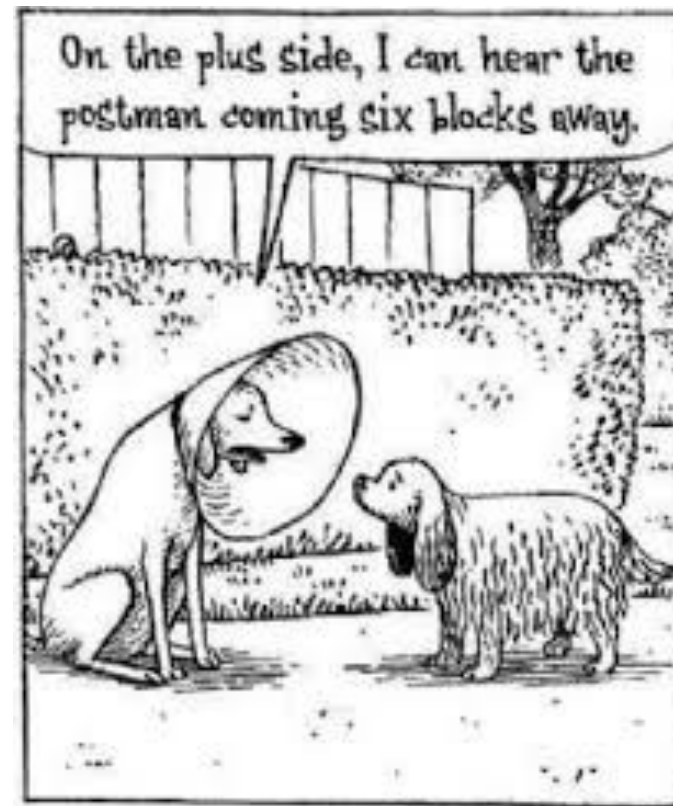



## Chairman's Challenge Results: *October 2018*

### Novice Group: Foot massager ( 2 entries)

1st Place: Mary Dunne



2nd Place: Les Wilkes



3rd Place:



### Intermediate Group: Platter with decorated rim ( 3 entries)

1st Place: Malcolm Edwards



2nd Place: Chris Jones



3rd Place: Graham Hunt



### Advanced Group: Bowl cut & reconstructed ( 3 entries)

1st Place: Malcolm Thorpe



2nd Place: Peter Hockley



3rd Place: Tim Davies



**Chairman's Challenge : November**

**Novice Group**

Xmas Decoration - Christmas Tree



**Intermediate Group**

Xmas Decoration - Angel



**Advanced Group**

Xmas Decoration - Free Choice



**October**

**Display Table** See website for index <https://www.wmwoodturners.org.uk>



**Chairman's Challenge ; NO Challenge for December**

A reminder from our Hon Treasurer

Annual subscriptions for the 2018/9 year will be confirmed at the Annual General Meeting and are due immediately thereafter. Please bring your cheque books (or lots of cash!)



---

### It's getting cold in the shed

Extract from Chestnut newsletter WEEK COMMENCING 28 OCTOBER 2018

Acrylic Lacquer and Acrylic Sanding Sealer at this time of year. If your workshop gets very cold it might be best to move these products (and the End Seal) indoors for the winter. If they get damaged by frost they will be rendered useless, the damage cannot be reversed. If affected, the liquid will form into ice crystals. The aerosol acrylics aren't prone to frost damage.

### Acknowledgment

Thank you to:

<b>Cliff Lane</b>	<b>Humour</b>
<b>John Hooper</b>	<b>Photos</b>
<b>Brian Goodall</b>	<b>Photo</b>
<b>Malcolm Caine</b>	<b>Paul Jones Demo Review</b>

---

**Phil , Malcolm and Steve are still working on their Through the key-hole stories, hopefully we should see these soon.**

**Please contact me if you are interested in taking part or want more information.**

If you have any articles or information on Wood Turning that you feel would benefit other member's of the club, please forward them to me and I will consider them for publication in the Club Newsletter

**Rob**

Editor@wmwoodturners.org.uk

Mobile 07767 344896

